

dimensions and technical description

Type	SAE Flare	Copper pipe		PS [bar]	Dimensions [mm]			Clamping torque Min/Max [Nm]	Weight [g]	Pieces per box
		Ø [in.]	Ø [mm]		ØD	L	CH			
FN2-2	1/4"	1/4"	6	45	6,5	15	17	11/14	18	100
FN3-3	3/8"	3/8"	-		9,7	19	22	20/25	35	100
FN3-2	3/8"	1/4"	6		6,5	19	22	11/14	36	100
FN3-M8	3/8"	-	8		8,3	19	22	20/25	36	100
FN3M-10	3/8"	-	10		10,3	19	22	20/25	35	100
FN4-4	1/2"	1/2"	-		13	22	25	34/47	48	100
FN4-3	1/2"	3/8"	-		9,7	22	25	20/25	53	100
FN4-M10	1/2"	-	10		10,3	22	25	34/47	52	100
FN4-M12	1/2"	-	12		12,3	22	25	34/47	50	100
FN5-5	5/8"	5/8"	16		16,3	24,5	28	54/75	65	50
FN5-4	5/8"	1/2"	-		13	24,5	28	34/47	69	50
FN5-M12	5/8"	-	12		12,3	24,5	28	54/75	70	50
FN6-6	3/4"	3/4"	-		19,4	29	33	68/71	97	25
FN6-M18	3/4"	-	18		18,3	29	33	68/71	98	25
FN7-7	7/8"	7/8"	22		22,5	31,8	41	90/120	165	25

» SAE Flare for inch and metric tubing

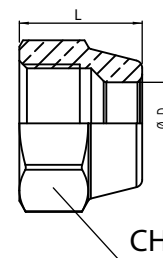

FN2-C	1/4"	-	-	45	-	15	17	11/14	20	100
-------	------	---	---	----	---	----	----	-------	----	-----

» SAE Flare Cap nuts

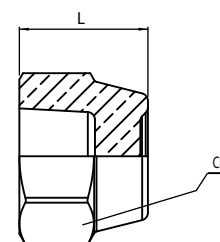

					L	Ch				
US4-4	1/4"	-	-	45	31	17	11/14	39	50	
US4-6	3/8"	-	-		39	22	20/25	70	50	
US4-8	1/2"	-	-		42	25	34/47	80	50	

» SAE Flare Twin nuts

